



The technology of tomorrow.

markilux MX-1 | The Ultimate One



reddot design award

markilux

safe timeless beautiful



markilux MX-1 | The Ultimate One Even at first glance, the markilux MX-1 makes an immediate impact with its unique mix of shape and functionality. Retracted, the tapered full cassette with a depth of 62 cm makes a deep impression on the observer as a weather-proof canopy that protects your awning from the effects of the weather. When extended the markilux MX-1 shows its true magnitude. This, the ultimate in designer awnings, is a pioneer due to the numerous technological innovations it incorporates and its multi-award winning design. The markilux MX-1 creates an unparalleled atmosphere at any time of the day, which will charm you again and again, today and in the future.

Dimensions

max. 700 cm × 437 cm,
overall depth approx. 62 cm

Folding arms

Bionic tendon

Options

Shadeplus,
a broad range of light
and colour options



LED spotlights in the canopy Highlight specific areas and enjoy the evening hours under the awning in a delightful atmosphere.

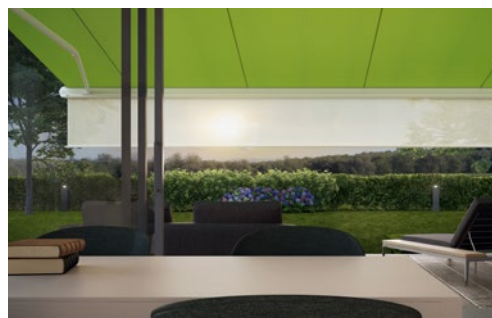

markilux Shadeplus The additional awning cover in the front profile protects against low-lying sun and prying eyes at the touch of a button.



Delivering beautiful protection,
any time of year.

markilux MX-1 Compact | The “Petite” Ultimate One



reddot design award

markilux
safe timeless beautiful



markilux MX-1 Compact | The “Petite” Ultimate One The “petite” markilux MX-1 with all the technological innovations and with the variety of features typical of markilux. It also offers you spectacular ambient lighting, brilliant LED options in the front profile as well as every possibility of influencing the colour design. The “petite” ultimate one makes your favourite spot in the garden particularly enticing. The markilux MX-1 Compact enhances the appearance of buildings with a modern, minimalist architectural design.

Dimensions
max. 700 cm × 415 cm,
overall depth approx. 38 cm

Folding arms
Bionic tendon

Options
Shadeplus,
a broad range of light
and colour options



Colour combinations Cassette and front panel are available in different colours, which can be combined freely.

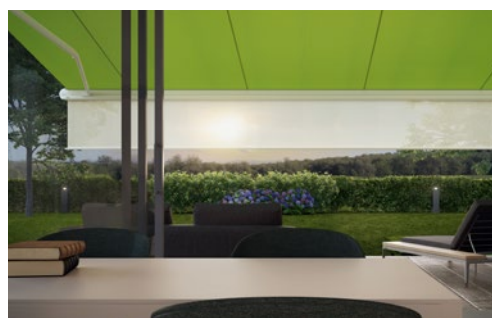

markilux Shadeplus At just the touch of a button, the optional protection from glare and prying eyes creates an enviable, private room outdoors. As standard, the Shadeplus is equipped with a radio-controlled motor and comes supplied with a markilux remote control.



The one that withstands
the elements.

markilux ES-1 | The Unique One



reddot design award

markilux
safe timeless beautiful



markilux ES-1 | The Unique One The world's only designer awning made of marine grade stainless steel is a design piece to fall in love with. The markilux ES-1 is a perfect combination of material, shape and function. This makes this awning a visual highlight, which will lose none of its magnificence even after many years, as the corrosion-resistant stainless steel will not fail you in even the stormiest of weather. With the markilux ES-1 you own a stylish treasure that brings you a great deal of pleasure and invites you to enjoy your outdoor life with sophistication.

Dimensions

max. 650 × 300 cm
max. 600 × 350 cm

Folding arm

gas piston

Options

valance



Valance This classic extension of the cover suspended from the front profile gives your stainless steel treasure a classy touch. Available in different shapes and manufactured to match the pattern of the awning cover.



Stainless steel gas pistons With impressive power, the perfectly matched gas piston technology of the folding arms is a visual highlight and ensures optimum cover tension – even when the awning is not extended completely.



Germany's Top Model.

markilux 6000 | The Individual One



DESIGNPREIS
NOMINEE



reddot design award

markilux

safe timeless beautiful



markilux 6000 | The Individual One A designer awning with many faces – each one more beautiful than the next. Create your own personal and unique model from a wide range of awning frame colours, decorative elements and available accessories.

With its remarkable dimensions and technical values, the markilux 6000 makes a lasting impression. It also cuts a dashing figure as well. Invite Germany's top model into your home.

Dimensions

max. 700 × 400 cm

Folding arm

Bionic tendon

Options

LED spotlights in the front profile, end cap insert in stainless steel mesh, frame in polished chrome, Shadeplus, valance, coupled unit



LED spotlights in the front profile More than a decorative highlight. The markilux 6000 lights up your favourite spot in an elegant, flexible and energy-efficient manner, just the way you want it.



Variable decorative elements Whether you choose the end cap insert in stainless steel mesh, the end cap trim in a chrome finish or all deliberately uniform in the awning colour of your choice – you can design your very own personalised top model by markilux.



Enjoy happy hour,
24 hours a day.

markilux 5010 | The Universal One



markilux
safe timeless beautiful



markilux 5010 | The Universal One The markilux 5010 effortlessly extends, either at the touch of a button or via smart control through an app, this awning will be a hit with all the family. On top of that, as a coupled unit with up to three awnings installed next to one another, friends and guests will also be able to find a cosy spot in the generous shade this awning offers. This multi-talent encourages relaxed get togethers and turns any hour spent outdoors into a happy hour.

Dimensions
max. 700 × 400 cm

Folding arm
double chain-link arms,
optional: Bionic tendon

Options
polished chrome fittings,
Shadeplus, valance,
coupled unit



markilux Shadeplus Enjoy relaxing on the patio even when the sun is low.



Polished chrome fittings Optionally available as an eye-catcher – and without surcharge, it's so friendly to your wallet: the chrome-look end caps fitted to the front profile.



Urban chic for a clean,
sleek appearance.

markilux 970 | The Linear One



markilux
safe timeless beautiful



markilux 970 | The Linear One This awning exudes urban lifestyle with confidence. The neat and slim appearance of the markilux 970 makes it the ideal model for those who love the simplicity of elegance. This svelte designer awning wraps your patio in comforting light and makes it a stylish place of retreat where your guests, too, will completely feel at home. The numerous styling options and the variable designs of the front panel lighting lend that individual something to the markilux 970. All in all, because of its clean lines and straightforward design, this awning is an all round performer.

Dimensions
 max. 600 × 300 cm
 max. 500 × 350 cm

Folding arm
 Bionic tendon

Options
 LED spotlights
 under the cassette,
 selectable colour combination,
 coloured front profiles,
 Shadeplus



LED spotlights under the cassette During the twilight and evening hours they ensure a stylish ambience.



Free colour choice The colours of the cassette and front panel can be freely combined. The front panel is also available in another six contrasting colours.





Create a carefree ambience.

markilux 990 | The Slim One



markilux
safe timeless beautiful



markilux 990 | The Slim One Small, but impressive! You will be surprised how much technological sophistication there is in this 125mm flat cassette. The compact construction with the U-shaped front profile in which the folding arms and awning cover disappear, and an impressive angle of pitch of up to 70 degrees when ceiling mounted make this awning best suited for smaller patios and balconies. Thanks to these advantages you can easily spend many hours relaxing in the shade.

Dimensions
max. 500 × 300 cm

Folding arm
double chain-link arms,
optional: Bionic tendon

Options
end caps in polished chrome,
valance



Wall sealing profile The slim aluminium profile in the awning colour closes the gap between the awning and the wall, allowing rain to be discreetly drained off the awning.



End caps in polished chrome
Add that certain extra touch to your markilux 990.



High Impact.
Low Maintenance.

markilux 3300 | The Practical One

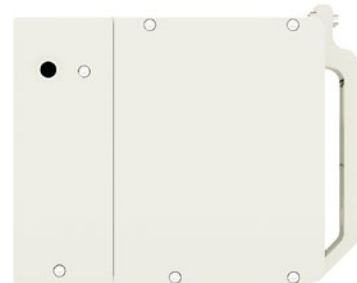

markilux
safe timeless beautiful



markilux 3300 | The Practical One Can an awning be merged visually into the architecture of a house? The markilux 3300 proves that it can. Depending on the structural situation, this designer awning, with its smooth front profile disappears completely into a wall or precisely into a recess.

When extended, it comes into its own with dimensions of up to 7 by 4 metres. And you can shade even larger areas by coupling up to three single awnings together.

Discover how practical the markilux 3300 can be, and make this awning a big hit in your home.

Dimensions

max. 700 × 400 cm

Folding arm

Bionic tendon

Options

valance,
coupled unit



Slim, compact shading
all year round.

markilux 1710 | The Classic One



German
Design Award

NOMINEE



reddot design award

markilux

safe timeless beautiful



markilux 1710 | The Classic One The markilux 1710 interprets the classic awning shape in a contemporary manner. The visible round torque bar merges organically with the round cassette to form an elegant design feature. Due to its shape and the timelessly beautiful decorative elements made from polished chrome, the markilux 1710 suits almost any patio.

Dimensions

max. 700 × 350 cm

Folding arm

Bionic tendon

Options

polished chrome fittings, valance, coupled unit, stretch

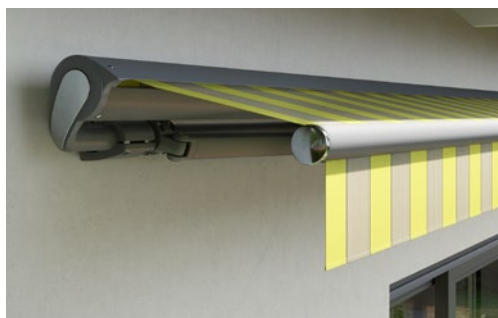

Polished chrome fittings Side caps matching the awning colour or deliberately emphasised in fine polished chrome. This awning can simply wear anything.



markilux 1710 stretch For great performance on narrow patios, balconies and recesses: Thanks to the two crossover arms even awnings with a narrow width can extend considerably further.



Perfect functionality meets
award winning design.

markilux 1600 | The Elegant One



markilux
safe timeless beautiful



markilux 1600 | The Elegant One This awning was awarded the IF product design award for its harmonious, semi-circular design. As a semi-cassette awning, the markilux 1600 is open to the bottom and still looks unique when it's fully extended. The top cover profile adapts itself to the angle of the pitch of the awning and closes completely flush with the front profile when retracted, which protects the cover safely from rain.

Dimensions

max. 710 × 400 cm

Folding arm

twin chain,
optional: Bionic tendon

Options

LED spotlights,
end caps in polished chrome,
Shadeplus, valance,
coupled unit, stretch



markilux Shadeplus Simply block out low-lying sun and prying eyes with the additional awning cover in the front profile of the markilux 1600.



markilux 1650 The model variant with swivelling dimmable LED spotlights in the front profile guarantees a pleasant ambience in the evening.



Perfect for balconies or eaves.

markilux 930 | The Mobile One



reddot design award

markilux

safe timeless beautiful



markilux 930 | The Mobile One This awning moves differently from the rest, because as you retract the markilux 930, the awning pivots into a horizontal position and disappears below the soffit. When extended, the angle of the pitch can be up to 80 degrees – so if required, the awning can pivot almost to the vertical. The markilux 930 is perfect for all balconies and eaves that require no additional protection of the awning or awning cover. This awning allows you to enjoy being outside in the evening even when the sun is low in the sky.

Dimensions
max. 500 × 300 cm

Folding arm
twin chain

Options
valance



Pivoting mechanism The only 122 mm high cassette disappears discreetly under the soffit, when retracted. Only during the extension process does the markilux 930 pivot to your desired angle.

Valance This additional decorative finish to the front profile lends the perfect balcony awning individual charm.



Open your mind to life outdoors.

markilux 1700 | The Open One

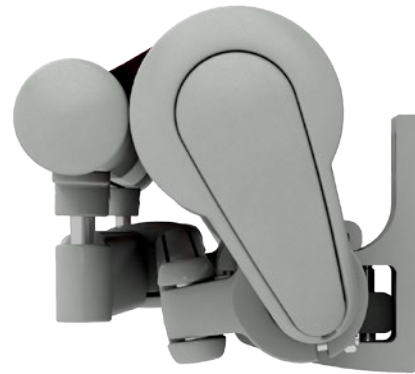

German
Design Award
NOMINEE

reddot design award

markilux
safe timeless beautiful



markilux 1700 | The Open One Whenever you would like to enjoy life outdoors, the open design of the markilux 1700 will create comfortable shading on your patio or balcony. Its organic design is elegant and timeless, and thanks to the stable support tube, it opens up the possibility to connect up to three awnings together, allowing the possibility to shade large areas without any problems.

Dimensions
max. 700 × 400 cm

Folding arm
Bionic tendon

Options
polished chrome fittings,
valance, coupled unit,
stretch



Polished chrome fittings Both the open markilux 1700 and its closed counterpart, the markilux 1710, can be embellished with polished end caps and inserts on request.

markilux 1700 stretch Available for narrow recesses and openings, with two crossover folding arms providing greater projection than width.



Always by your side.

markilux 790 | The Upright One



markilux
safe timeless beautiful



markilux 790 | The Upright One There are few seating areas outdoors that are protected on all sides from sun wind and prying eyes. Therefore, the slim markilux side screen simply makes your life on balcony or patio more comfortable and enticing. The robust compact cassette can be mounted easily and it can be extended with one movement. The markilux 790 is always by your side when you need it and whenever you feel like making use of its benefits.

Dimensions

extension: max. 450 cm
height: 90 cm – 250 cm

Options

sloping top edge,
mobilfix,
various installation
bracket options



A broad range of brackets For any situation markilux has an apt installation option.



mobilfix The moving support post with granite baseplate stands secure, wherever you want it to.

02/2018 - We reserve the right to make technical modifications without giving prior notice.



Here's to getting together,
whatever the weather.

markilux pergola



German
Design Award
SPECIAL
MENTION



markilux

safe timeless beautiful



markilux pergola The markilux pergola ranks top when it comes to solar and wet weather protection. The awning system on slender posts and lateral guide tracks provides generous shading with an extension of up to 6 metres. The markilux pergola defies wind and weather up to Beaufort 6 (wind resistance class 3). You can make this awning your own with markilux's Shadeplus, tracfix, an array of lighting options and post variants. No matter how strong the sun shines or the wind blows, with your markilux pergola you can enjoy life outdoors at any time.

Dimensions

max. 600 × 450 cm
max. 500 × 600 cm

Options

tracfix, Shadeplus and a number of other comfort and design options



LED line Light for reading or informal get-togethers, optionally in the guide tracks and/or in the cover support tube, turns your night into day.



markilux sundrive An integrated solar panel drives the Shadeplus motor (optional). When the awning is extended the front profile and the guide tracks match one another perfectly.



Square support / baseplate covers meets the demand for clear, angular shapes and a clean finish at the base of the front support posts.

Stabilisation boxes Give your markilux pergola reliable stability, when fitting the front posts to foundations is not possible or desired.



The planet really does revolve around you.

markilux planet



markilux
safe timeless beautiful



markilux planet The markilux planet is a parasol and awning in one. It's an eye-catcher that provides perfect shading for your room outdoors. This awning-cum-parasol protects you from solar radiation with exceptional reliability; it's extremely sturdy, yet mobile. With the easy to use lever in the flex variant, you can simply rotate it by up to 335°, so you can have shade wherever it is required. The slim post carries the selected markilux designer awning with ease and the combination of functionality and design is impressive.

Dimensions

depending on awning model
 max. 600 / 610 cm × 300 cm
 max. 500 / 510 cm × 350 cm

Folding arm

depends on model

Options

depending on awning model,
 flex rotates up to 335 degrees



flex option The markilux planet can be rotated by up to 335° and positioned wherever you need shading. The Easy-go lever permits easy rotation, locking and unlocking of the markilux planet flex.



Allow them to stand on their own two feet.

markilux syncra



markilux
safe timeless beautiful



markilux syncra The markilux syncra promises generous shading right where you need it. As a single unit up to 60 m²; as a coupled unit even larger areas are no problem. This free-standing awning literally stands on its own two feet, two round or square posts and a massive cross beam ensure reliable stability. Depending on the requirement, one or two folding arm awnings or markilux pergolas can be attached to it. This awning system is either firmly anchored to the ground (“fix”) or installed using stabilisation boxes (“flex”).

No matter which variant you choose, you can count on the markilux syncra.

Dimensions

depending on the model up to 60 m², as a coupled unit even larger

Folding arm

depends on the model

Options

depending on the awning, uno (only one awning/pergola), flex (with stabilisation boxes), round / angular posts, coupled unit



markilux syncra uno



markilux syncra pergola



markilux syncra flex



When you need just that little bit more.

markilux construct



markilux
safe timeless beautiful



markilux construct There are situations where a standard model is not enough to meet your special requirements. In these situations system solutions are required. The frame system markilux construct is extremely versatile and flexible. Different modules unite with different awnings to create a veritable awning landscape. You don't have to make any compromises when it comes to size, and the range of available accessories is impressive. You can choose between round and angular posts. It is almost impossible to describe the markilux construct: you just simply have to experience it in your own garden.

Dimensions

almost unlimited thanks to modular and flexible frame system

Options

depending on awning model, round / angular posts, triangular acrylic windows or covers for the gable ends, baseplate covers



Designer awnings to your own precise specification

Different conservatory and folding arm awnings are possible and can be combined with vertical blinds or side screens according to your wishes.



NEW

The free-standing shading system against sun, wind and rain

Make the rain take a detour.

markilux markant



markilux
safe timeless beautiful



markilux markant The free-standing shading system markilux markant is protection against sun, wind and rain, that can be tailored to your precise requirements. The awnings, integrated into the frame, lend the system a textile character, their fabrics making it possible to create the pleasant colour ambience you have in mind.

The markant offers protection, security, freedom, outstanding looks and comfort in a purist design.

Dimensions

Max. post separation up to 600 cm × 600 cm with two independently functioning awnings, as a single unit up to 300 cm × 600 cm, overall height 260 cm, other heights are possible

Options

LED lighting, infrared heaters, vertical cassette blinds



On request – that little bit more From the atmosphere-creating lighting right down to the heaters, the markilux markant fulfils all your wishes as far as the creation of an al fresco oasis of relaxation goes.



Just what you need – regardless of the weather Ideal lifestyle pleasure on the patio or in the garden – in just about any weather and at any time of the year.